

## MODEL: ASI 7000 WET-WET MEMS Differential Pressure Transmitter



ASI 7000 series is media isolated differential pressure transmitters consists of both isolation membrane differential pressure sensor and integrated circuits. It has characteristics of high precision, good stability, high reliability and good sensibility. It has built-in high-performance microprocessor (MCU) which can correct nonlinearity and compensate temperature drift to measure and control for liquid and gas.

### APPLICATIONS:

- Pressure Instrumentation
- Water Level
- Boiler Controls
- Pneumatics
- HVAC/R Systems
- Filtration

### BENEFITS:

- Low Static and Thermal Errors
- Wide Operating Temperature Range
- Compact Size

### PERFORMANCE @ 25°C (77°F)

Accuracy*	<±0.4% typ.
Stability (1 year)	<±0.25% typ.
Pressure Range	Up to 300PSI
Common Line Pressure	500PSI
Burst Pressure	3X Full Scale
Pressure Cycles	4 million cycles

Output	Excitation	Zero Offset	Span Tolerance
0-5V	10-30VDC	<±0.5% of FS	<±1% of FS
1-5V			
4-20mA			
0.5-4.5V Ratiometric	5VDC typ.		

Reverse Polarity Protection Yes

\* Accuracy includes non-linearity, hysteresis & non-repeatability

### PHYSICAL DESCRIPTION

Wetted Material	316L-SS
Weight	150g
Electrical Connection	Packard, Mini Din 43650C, M12

### ENVIRONMENTAL DATA

#### Temperature

Operating	-40 to 105°C
Storage	-40 to 125°C

#### Thermal Limits

Compensated Range	-0°C to 70°C (32 to 158°F)
TC Zero	< ±1.5% of FS
TC Span	< ±1.5% of FS

#### Other

Shock	100 (11 mS)
Vibration	20g (20-5000HZ)
EMI/RFI Protection	Yes
Rating	IP-65

## ORDERING INFORMATION

**ASI 7000** D A 00002 P 4 E 1 000

Series Type

**Pressure Reference**

D=Differential

**Process Connection**

A=1/4 MNPT  
I=1/4 FNPT  
J=1/8 FNPT  
R=7/16-20UNF Female

**Pressure Measurement**

Insert pressure code from chart

**Pressure Unit**

P=PSI

**Outputs**

1= 0.5-4.5V Ratiometric  
2=0-5V  
3=1-5V  
4=4-20mA

**Electrical**

E=Mini Din 43650C  
K=Deutsch DT04-3P  
Z=Deutsch DT04-4P  
F=Packard Metrick  
A=2ft. (0.6m)  
C=6ft. (1.8m)  
D=10ft. (3.0m)  
Y=M12x1  
X=Special

**Wetted Material**

1=316L

**Options**

000=No Options

### PRESSURE RANGES

PSID Measurement	Pressure Code
0-2	00002
0-5	00005
0-10	00010
0-30	00030
0-100	00100
0-300	00300

All Pressure between 0 to 2PSID and 0 to 100PSID available.

### DIMENSIONAL DRAWING

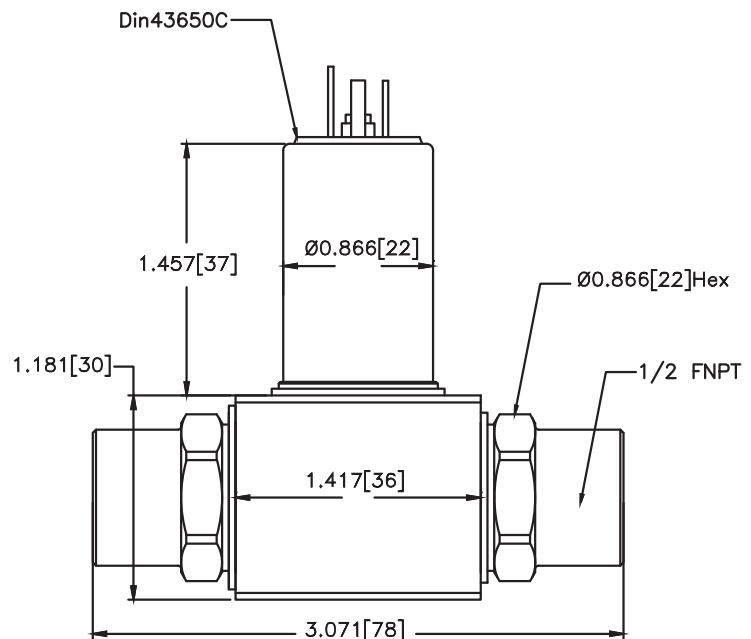

Dimension in inches [mm]

Sold in North America by:  
**Servoflo Corporation**  
75 Allen Street  
Lexington, MA 02421  
781-862-9572  
[www.servoflo.com/](http://www.servoflo.com/)  
[info@servoflo.com](mailto:info@servoflo.com)

All specifications are for reference purposes only. In the interests of continuous product improvement, all specifications are subject to change without notice. Please contact ASI 7000 for assistance with your application.

**Standard configurations shown.**  
Please consult factory for other options.